



Station Certification Application

Site Plan Drawing

Inspection Facility Requirements

Your emissions inspection facility must be built or arranged in a manner that will allow an emissions inspection to be performed according to Georgia Inspection and Maintenance (I/M) Program rules (Chapter 391-3-20-09).

The Georgia Analyzer System (GAS) unit was designed and certified to operate accurately between 41 and 110 degrees Fahrenheit. Use of the GAS unit outside this temperature range is not allowed.

Note: This can be difficult if the GAS unit is located in an enclosure that separates or insulates it from the test lane, particularly in a drive-thru type station. In these situations, the enclosure must be adequately ventilated to the same environment as the vehicle.

Analyzer(s) must be accessible to enable GCAF auditors and/or EPD the ability to verify serial and model numbers.

You must follow these requirements when drawing your site diagram. The diagram must include identification of:

1. All bays in the building.
2. All rooms in the building.
3. The placement of your analyzer.
4. A designated viewing area where the motorist can sit and observe the test taking place. If this is not a separate room, the viewing area must be clearly marked out on the floor. This space should either be covered or enclosed, allowing the motorist to remain dry in inclement weather. CCTV is also acceptable and the camera and monitor should be clearly marked on the diagram.
5. The location where you will place all motorist information (ex: Q&A brochures).
6. The location where you will hang the station certificate.
7. All entrances and exits into and out of the building.
8. Show the road the station is on and any adjacent roads, if applicable.

After identifying a potential inspection facility or developing blue prints, a Station Certification Application must be completed, to which a site diagram (as referenced above) should be attached along with various other documents, and submitted online. All documents can be found on our website (www.cleanairforce.com).

Failure to accurately complete this form or submit requested information will delay the opening of your station.

If you have any questions, [please email GCAF at industry@cleanairforce.com](mailto:industry@cleanairforce.com).



Station Certification Application Site Plan Drawing

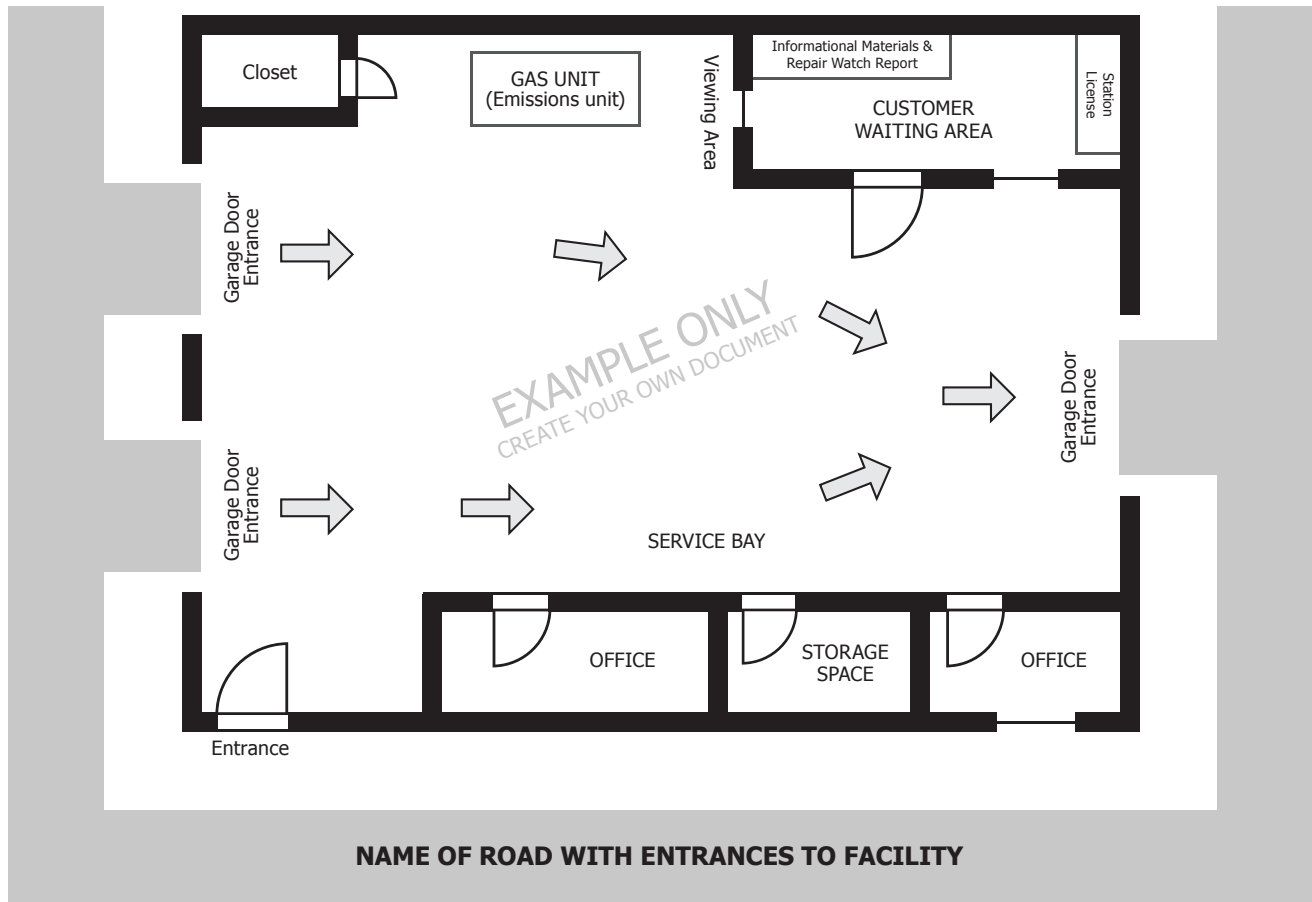

GCAF SITE PLAN DRAWING